

## Specifications

# ArroTop

General	
Frequency Range	VHF:136-174MHz/UHF:350-390MHz/400-470MHz/450-520MHz
Channel Capacity	160
Zones	50
Channel Spacing	12.5KHz
Working Voltage	DC 13.8V(±15%)
Frequency Stability	±1.5ppm
Antenna Impedance	50Ω
Dimensions	156*158*47mm (L/W/H)
Weight	1.29Kg
Transmitter	
Power Output	VHF/UHF H:30W VHF/UHF L:10W
4FSK Modulation	12.5KHz (data only): 7K60FXD 12.5KkHz (data and voice): 7K60FXE
FM Modulation	12.5 KHz: 8K50F3E
Modulation Limitation	+/- 2.5KHz @ 12.5KHz
FM Noise	-40dB
Spurious Emission	-36 dBm≤1GHz/-30 dBm≥1GHz
Adjacent Channel Power	≤-60dB
Frequency Response	+1/-3 dB
Audio Distortion	<3%
Vocoder	AMBE+2™
Receiver	
Digital Sensitivity	5% BER: 0.25 uV
Analog Sensitivity	0.25 uV (12 dB SINAD)
Intermodulation	60dB
Adjacent Channel Selectivity	60 dB
Spurious Response Rejection	70 dB
FM Noise	-40dB
Frequency Response	+1/-3 dB
Audio Power	3W
Audio Distortion	3%(typical)
Conduction Radiation	-57dBm
GPS Precision	Horizontal Accuracy≤-10m (in good condition)
TTFF (first location)Cold Boot	< 1 minute (good signal)
TTFF (first location)Hot Boot	< 10 seconds (good signal)
Environmental Specifications	
Working Temperature	-20°C-+70°C
Storage Temperature	-40°C-+80°C



## BF-TM8250

DMR DMR Mobile Radio

# ArroTop

גם בשפה העברית!

BF-TM8250 comes with a large size color display which delivers good visibility even under strong light environments. Also, the five programmable buttons allow the user to access any features he needs and thus greatly facilitate radio communications. Besides a full set of digital features, the integrated remote kill/stun/revive features bring unprecedented efficiency to teamwork and radio management.

Digital/analog Dual Modes  
ETSI DMR Tier I And Tier II  
Power-on Password  
Built-in GPS Positioning  
IP54 Protection



### ARROWMID GROUP LTD.

Address: Igal Alon 127, Tel Aviv  
Phone: 972-3-6247080 Fax: 972-3-5620208  
E-Mail: info@arrowmid.com

www.arrowmid.com



All rights reserved by arrowmid. Pictures shown in this manual are for your reference only, if there is fluctuation, according to the real object, please.



# ArroTop

## BF-TM8250

Commercial DMR Radios



### Highlights

#### Transmit Interrupt

This function enables a supervisor to interrupt a radio conversation in order to clear a channel for more important communications.

#### Radio Priority-Based Interruption

This function enables a radio with higher level to interrupt communications between radios with lower levels, giving higher priority to radios with higher levels. This means better dispatching efficiency.

#### GPS

BF-TM8250 can send location information to the command center and the commander can view GPS information in realtime, which increases commanding efficiency and personnel safety.

#### TTS (Text-to-Sound)

The integrated TTS function will automatically transfer all the text messages into voice, so that the user does not need to read and can therefore better focus his eyes and attention on the mission.

#### Remote Kill/Revive

Such functions greatly facilitate dispatching work and can be especially useful if you want to kill a lost radio.

#### Secure Communications

Use digital encryption to code and decode all voice calls, and support both dynamic and static encryption for secure communications.

#### SMS

BF-TM8250 supports messages with up to 140 characters when discreet communications are needed.

### Features

#### Main Features

- Digital/analog Dual Modes
- TTS
- Scan/Monitor
- IP54 Protection
- High/Low Power Switchable
- Secure Communications



#### Digital Features

- Private Call
- Group Call
- All Call
- Radio Check
- Remote Kill/Revive
- Remote Monitor
- Emergency Alarm
- Digital Encryption
- SMS
- Roaming

#### Analog Features

- CTCSS/DCS
- Squelch Levels
- Busy Channel Lockout
- Narrow/Wide Band

גם בשפה העברית!

#### DMO True 2-Slot

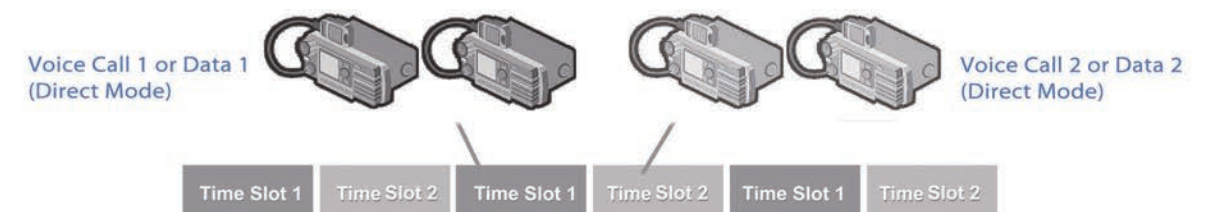

#### Standard Accessories

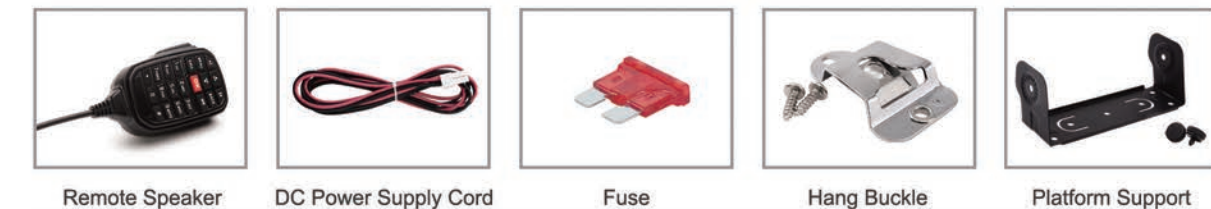

#### Optional Accessories

